

A wspornik do montażu przegrody szklanej do blatu | bracket for glass screen installed to table top

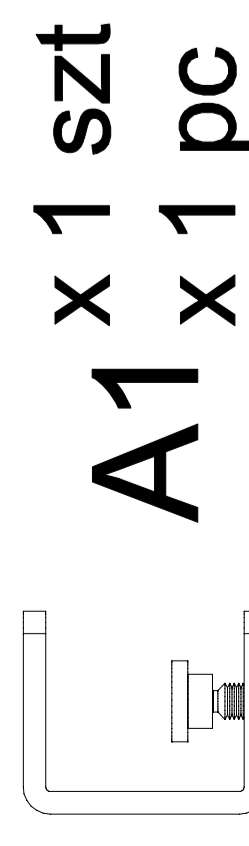

A1 x 1 szt
x 1 pc

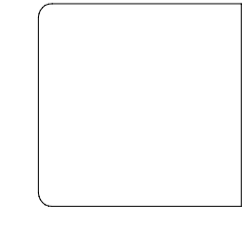

A2 x 1 szt
x 1 pc

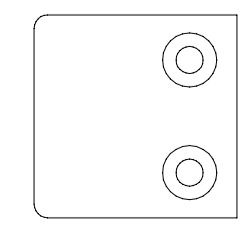

A3 x 1 szt
x 1 pc

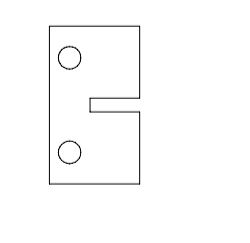

A4 x 2 szt
x 2 pcs

B podkładka filcowa x 1 szt | felt pad x 1 pc

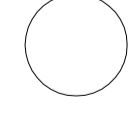

C klucz imbusowy x 1 szt | allen key x 1 pc

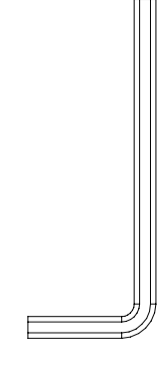

D śruba x 1 szt | screw x 1 pc

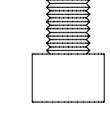

E śruba x 2 szt | screw x 2 pcs

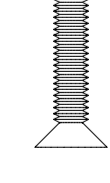

F zaślepka x 2 szt | end plug x 2 pcs

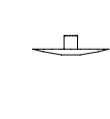

INSTRUKCJA MONTAŻU I ASSEMBLY INSTRUCTION

M-AS-060-6, M-AS-060-6IN, M-AS-060-8, M-AS-060-8IN

2020.07

1

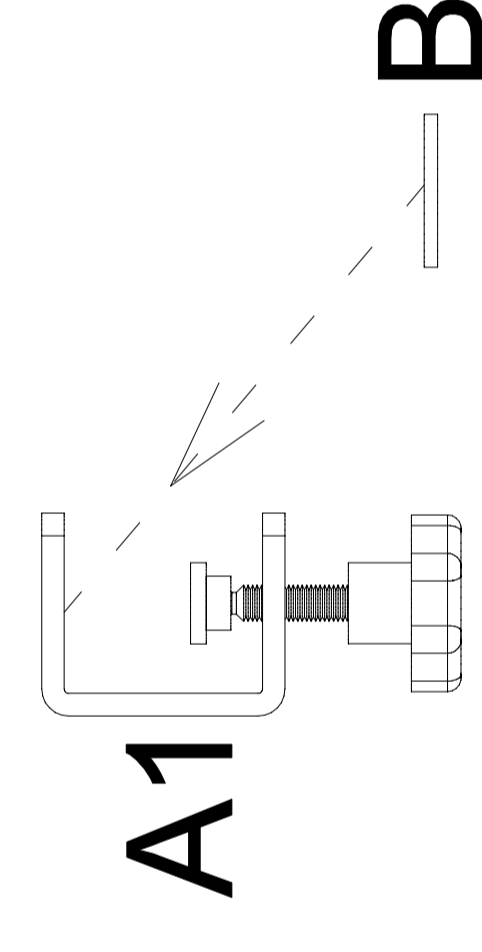

2

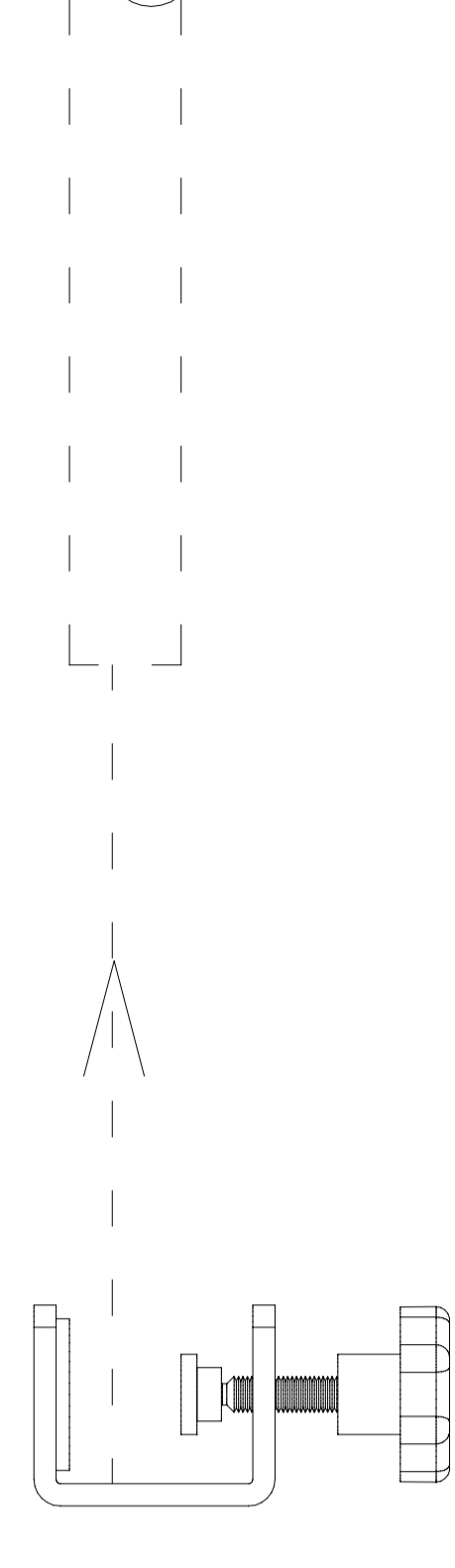

3

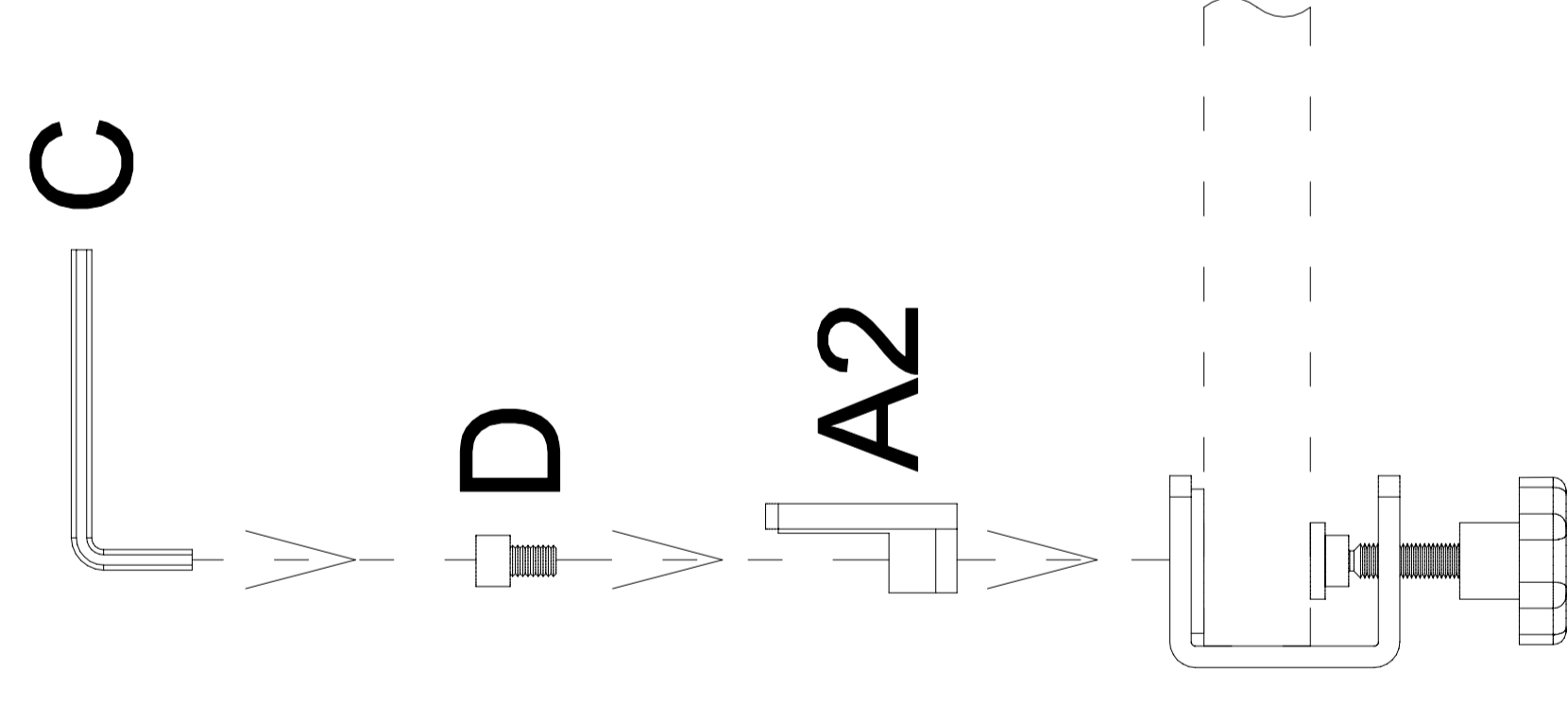

4

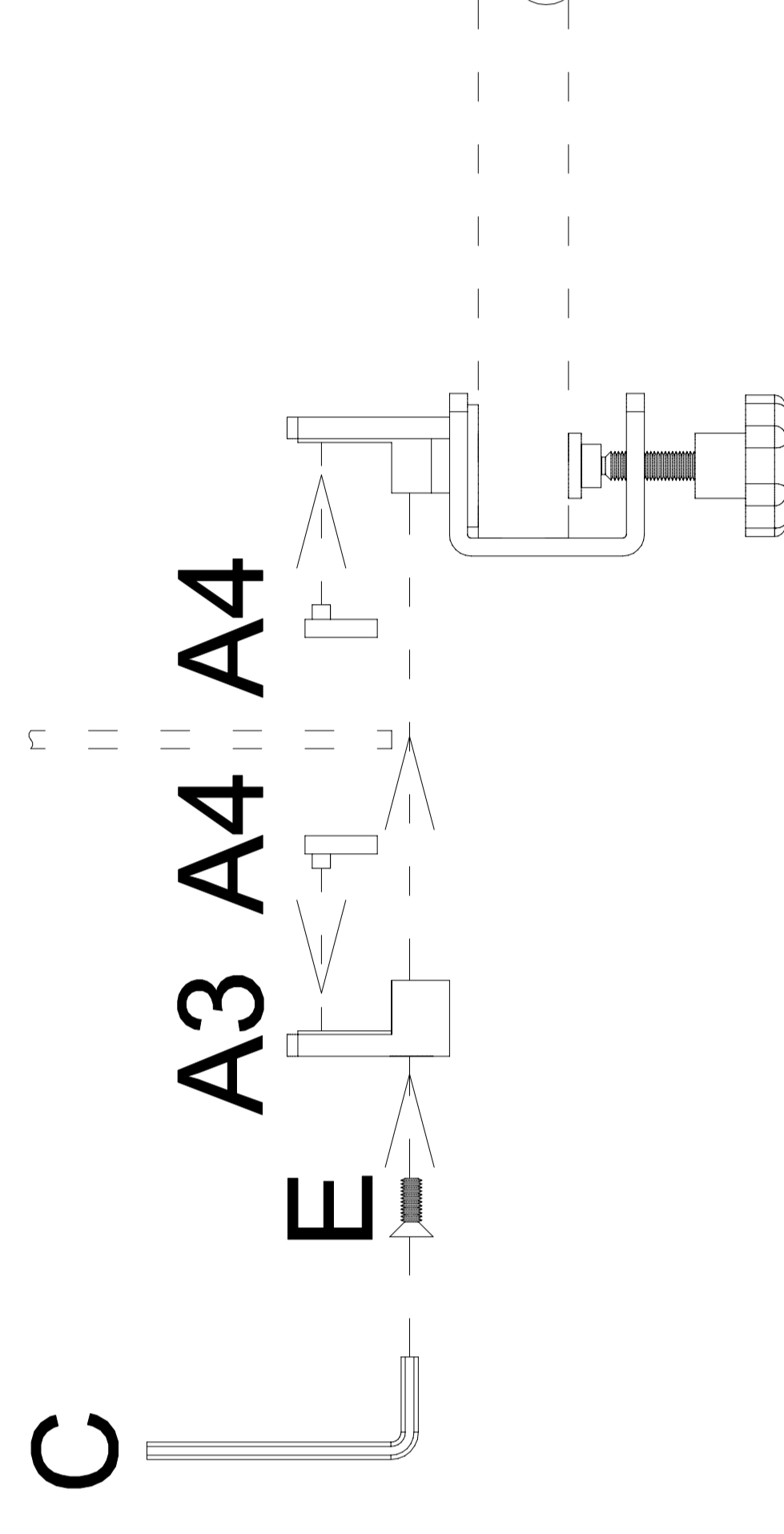

5

