

A noga x 1 szt | leg x 1 pc

A1

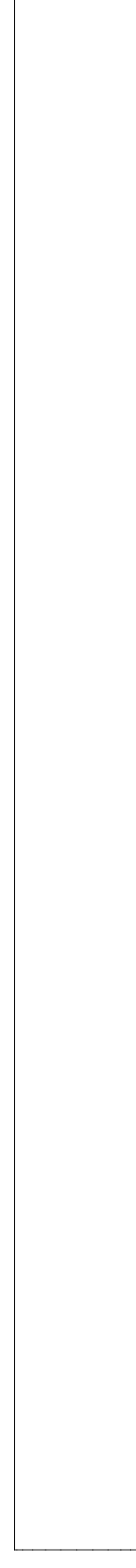

A2

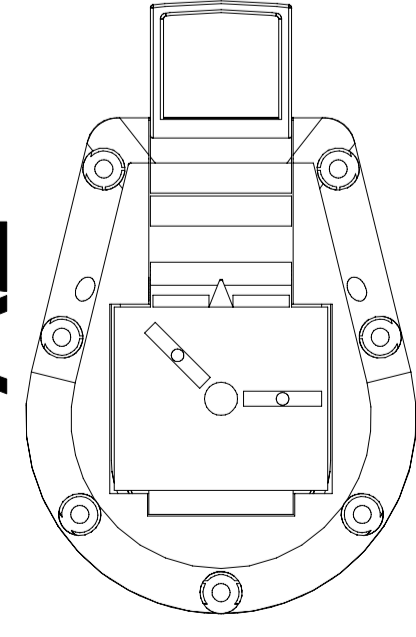

B regulator x 1 szt | adjuster x 1 pc

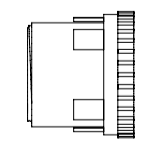

C klucz imbusowy x 1 szt | allen key x 1 pc

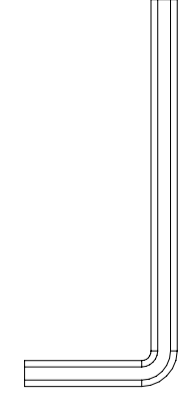

D śruba x 1 szt | screw x 1 pc



E wkręt x 7 szt | sharp screw x 7 pcs



potrzebne narzędzia | necessary tools



INSTRUKCJA MONTAŻU | ASSEMBLY INSTRUCTION

ST 606 U

2020.09

1

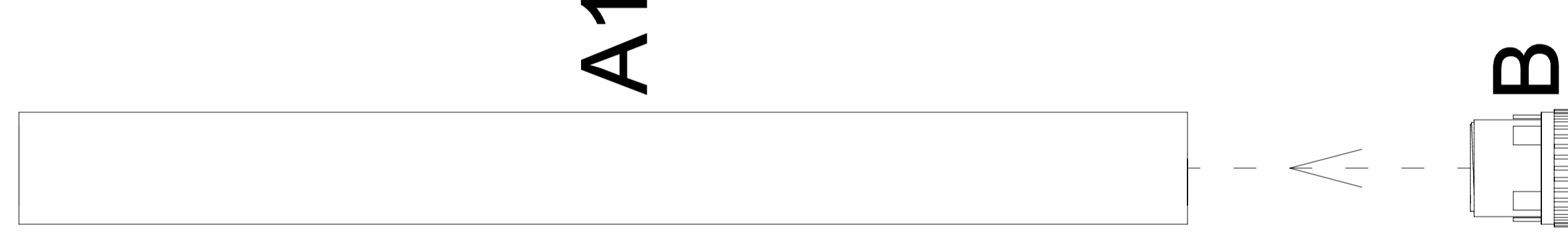

2

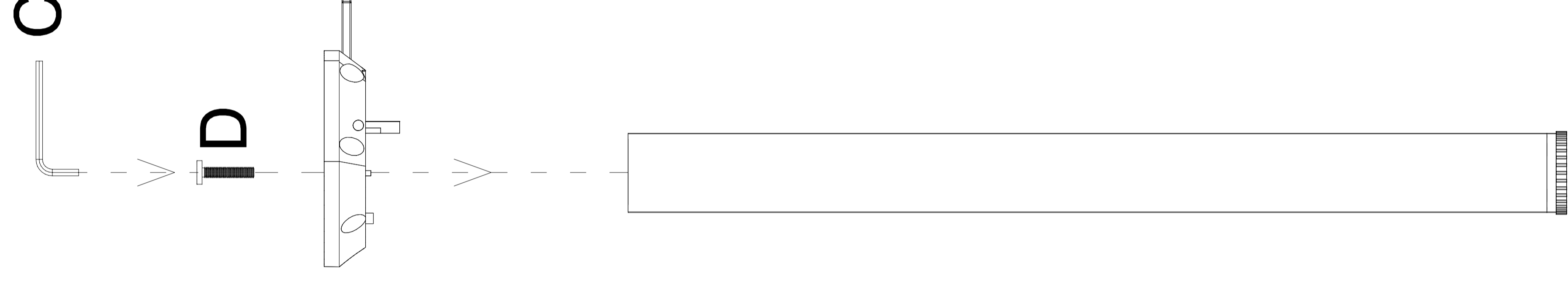

3

